

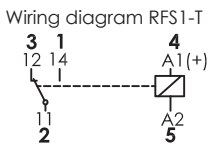

RF1-T Relay 1 contact

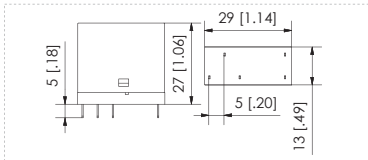

Dimensions RFS1-T



Coil temperature RFS1-T

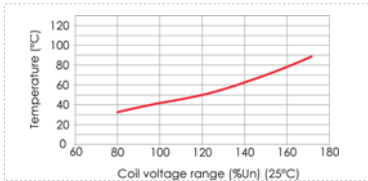

RF2-T Relay 2 contacts

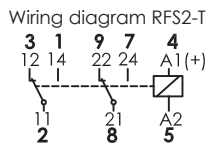

Dimensions RFS2-T

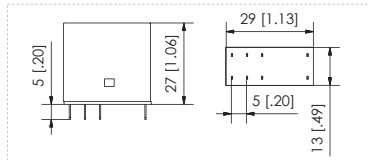

Electrical life RFS1-T

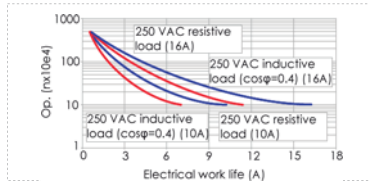

Coil temperature RFS2-T

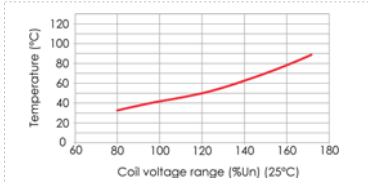

Electrical life RFS2-T

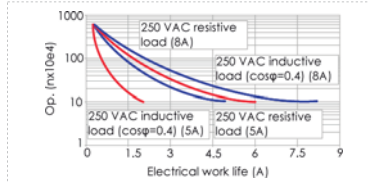

Features

Industrial interface relay for general applications. Available in 1 & 2 change-over contacts with max. current 10 & 16 A - 250VAC1/30VDC1 and 5A & 8 A - 250 VAC1/30VDC1. Coil nominal power DC 0,53 W & AC 1,1 VA. Available with or without led for AC/DC relays. Diode only available in DC. Insulation: IEC61810-1 - 2,5 Kv/3. Pollution degree 2. Socket 187 (4,75 mm) terminals. Approvals: CE, UL. Protection class: IP40. European Patent.

Coil ratings

Nominal voltage VDC	6	12	24	48	115	-
Resistance ($\Omega \pm 10\%$)	68	259	939	4,2K	20,9K	-
Nominal voltage VAC	6	12	24	48	120	230
Resistance ($\Omega \pm 10\%$)	17	63	250	1,1K	5,17K	20K

Coil values at 25 °C

	VDC	VAC 50HZ
Operating range	0,75 - 1,1 Un	0,8 - 1,1 Un
Max. drop-out voltage	$\geq 10\%$ Un	$\geq 30\%$ Un

Contacts

Contact arrangement: 1C and 2C. Maximum contact power(230VAC1/28VDC1): 1C:2.500 VA / 300 W, 2C: 1.250VA / 150W. Maximum voltage: 250 VAC / 220 VDC. Maximum current: 10 A & 16A 1C and 8 A & 5A 2C AC1/DC1. Maximum breaking capacity: 110V DC ----> 0,4A 220V DC ----> 0,15-0,20A. Contact resistance: ≤ 50 m Ω . Contact material: Silver alloy (m + Ag + Hi).

Specifications RF-T

Electrical life	$\geq 10^5$ cycles
Mechanical life	$\geq 10^7$ cycles
Insulation resistance	$\leq 1000M\Omega(500VDC)$
Operation time	≤ 20 ms
Operation frequency	1200op/h at nominal load
Release time	≤ 10 ms
Dielectric strength at 1mA	5.000VAC/1min(between coil and contacts) 1.000VAC/1min(between contacts)
Vibration resistance	10 - 50Hz (Double width 1,5mm)
Shock resistance	10g
Room temperature	-40 °C +65 °C
Room humidity	35% -85% RH
Armospheric pressure	86 - 106 KPa
Weight	20gr
Pack units	50

References RF-T relays

Example: Relay RF. 2 contacts, 230VAC coil voltage, without LED.

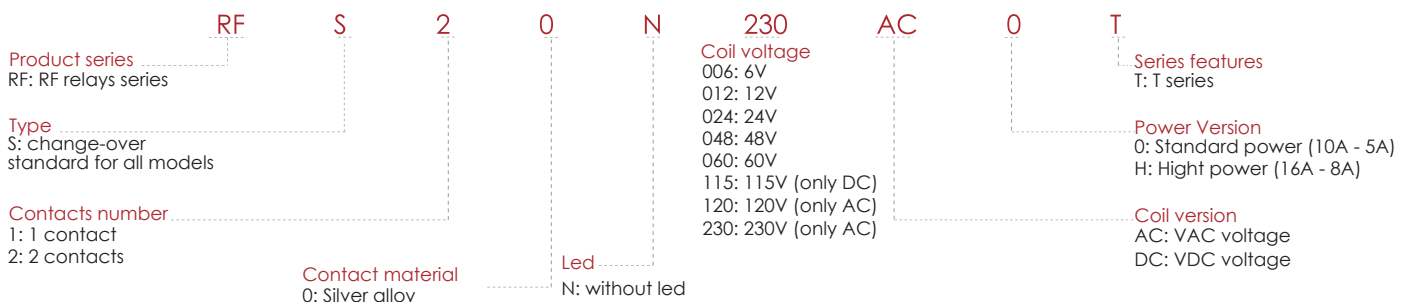



SFB1-T Socket

SFB2-T Socket

Wiring diagram SFB1-T



Wiring diagram SFB2-T



Dimensions SFB1-T

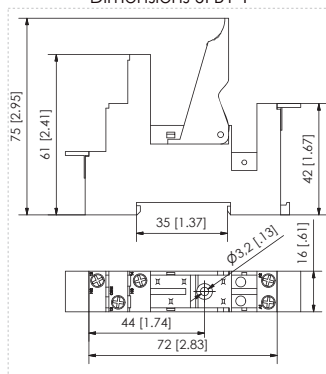

Dimensions SFB2-T

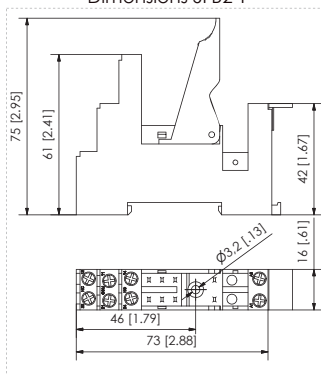

References

Reference	Contacts	Connection
SFB11C00T	1	Socket for relays 1 contact black
SFB10C00T	1	Socket for relays 1 contact grey
SFC11C11T	1	Weld-on PCB sockets 1 contact relay black
SFB21C00T	2	Socket for relays 2 contacts black
SFB20C00T	2	Socket for relays 2 contacts grey
SFC21C11T	2	Weld-on PCB sockets 2 contacts relays black

Series - T modules

	M12-LM-AA	6/230 VDC protection diode (A1-)
	M22-LM-AB	6/230 VDC protection diode (A1+)
	M32-LM-BC	6/24 VDC protection diode & led (A1-)
	M32-LM-BC	6/24 VDC protection diode & led (A1+)
	M52-LM-DK	110/230 VAC RC supressor
	M62-LM-EM	24/60 VAC/DC with led
	M92-LM-EN	110/230 VAC/DC with led

Series - T modules - diagrams

M12 (LM-AA) 6/230 VDC	M22 (LM-AB) 6/230 VDC	M32 (LM-BC) 6/24 VDC	M42 (LM-CF) 6/24 VDC	M52 (LM-DK) 110/230 VAC	M62 (LM-EM) 24/60 VAC-DC	M92 (LM-EN) 110/230 VAC-DC

Features

- Interface I/O (Input/Output)
- DIN rail (35 mm, T35) or panel mount (EN 60715)
- PCB relays and electronic modules allowed
- According to IEC(EN 61812/1/4)
- DIN/EN sequential numbering

Specifications

- Nominal load 1C: 16A (250 V); 2C: 8A (250V)
- Dielectric strength Vrms/1min 2,5 KV
- Max. screw torque 1,2 Nm
- Screws M3 Steel. Pozi drive
- Quick Clamp Stainless steel
- Wire in lets capacity: solid wire 4 mm² or 2 x 2,25 mm²
- Wire in lets capacity: multi-core 22 – 14 AWG
- Weight ≤46gr
- Room Temperature -40°C to 70°C
- Pack Units 20
- Protection Category IP 20

Weld-ong PCB sockets SFC

- Weight 3gr
- Pack Units 100

